

## Preparation and suitability test

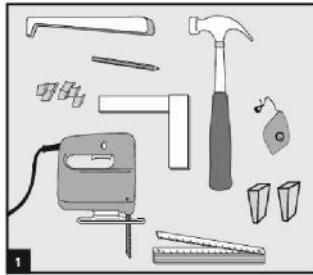

### [1]

Tools required:

Jigsaw, engineer's square, pull bar, spacers, pencil, folding rule, fitting tool, hammer, chalk line



### [2]

Acclimatisation:

Stack unopened packages flat in small quantities (packaging film does not provide protection against moisture).

Leave for 24 hours in the following room conditions:

Floor temperature min. 15°C–max. 24°C

Room temperature min. 18°C–max. 25°C

Humidity >40%<65%

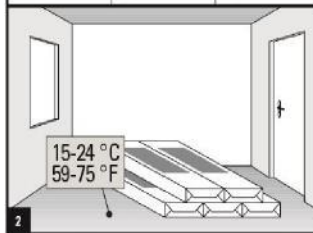

### [3]

Residual humidity:

Substrate must be permanently dry.

Max. residual humidity: AE ≤ 0.5%CM and CT ≤ 2.0%CM

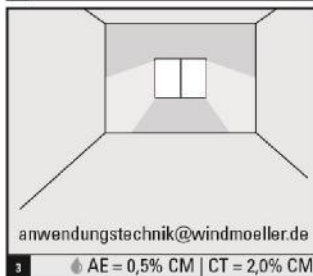

### [4]

Residual humidity for warm water underfloor heating.

Preheating ready for installing must be completed and documented.

Max. residual humidity: AE ≤ 0.3%CM and CT ≤ 1.8%CM

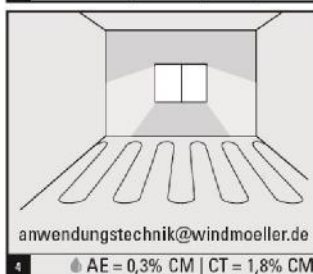

### [5]

The substrate must be level.

Unevenness must be 3mm/m or less; 1mm/10cm for tile edges. Greater unevenness can lead to irreparable damage to the floor covering and should therefore be corrected beforehand.

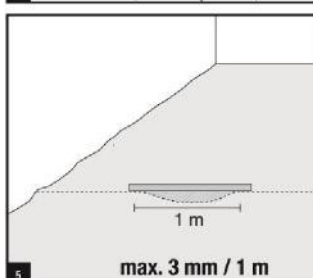

### [6]

The substrate must be stable and have adequate tensile and compressive strength.

Textile floor coverings must be removed.

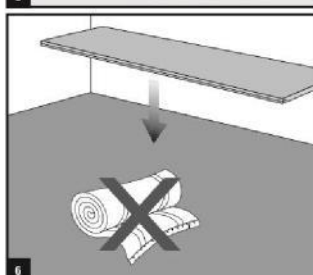

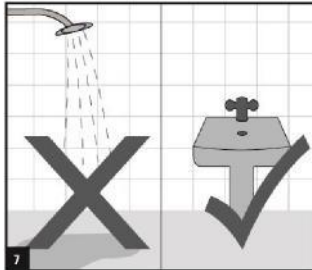

**[7]**

wineo all-in-one laminate floor systems are suitable for use in rooms prone to damp.

All-in-one laminate floor systems are not suitable for use in wet areas with floor drains, e.g. showers.

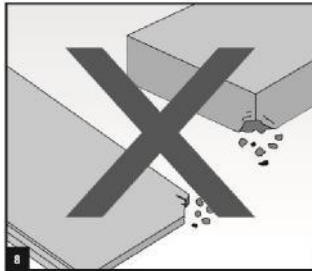

**[8]**

Before starting work, ensure the delivered product is in perfect condition: complaints cannot be made once the product has been cut or installed.



**[9]**

The substrate must be free of dust and contamination.

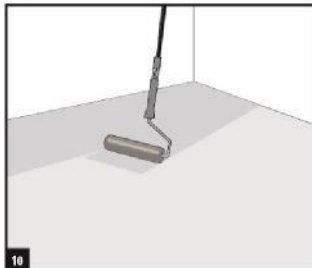

**[10]**

In order to achieve optimum adhesion, all mineral substrates should be pre-treated with a suitable dispersion primer.

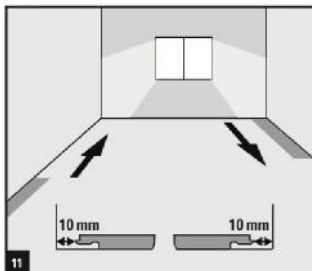

**[11]**

Ensure there is a completely consistent expansion joint with a minimum width of 10mm to all raised components.

Install the panels with the front side facing the main source of light in the room.

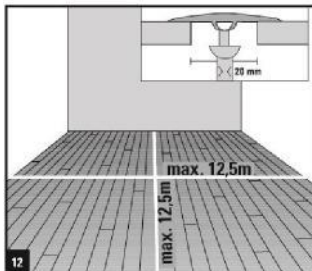

**[12]**

The flooring can be installed without a joint in rooms with an uninterrupted surface area of 150m<sup>2</sup> (max. side length 12.5m). Room areas that are interrupted by rising elements (pillars, partitions, doorways and the like) must be separated by expansion joints of at least 10mm around the element.

## Installation

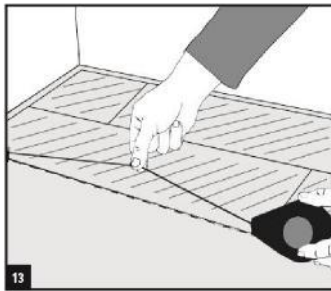

### [13]

We recommend you mark the dimensions of the first two sets of panels, including the edge distance, with a chalk line on the substrate.

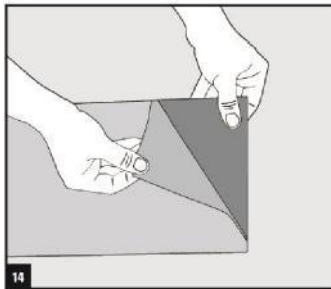

### [14/15]

Start with a whole panel in the second row. Remove the protective film from the reverse side of the panel and lay it along the marked chalk line.

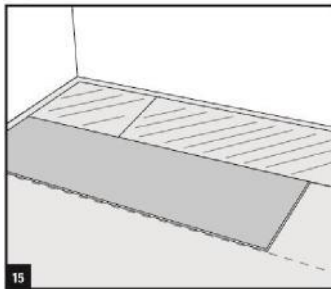

### [16]

To ensure the panel is laid perpendicularly, we recommend completing the first two rows using the prescribed joint offset.

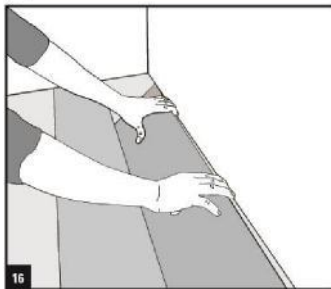

### [17]

Fold-Down locking.

Set subsequent rows in the lateral groove at an angle of 30°, overlap the tongue and groove end connections perfectly and press in place with light pressure.

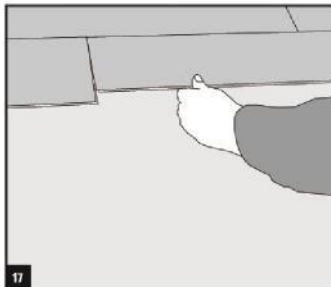

## Installation instructions for wineo performance laminate flooring – Rock'n'Go

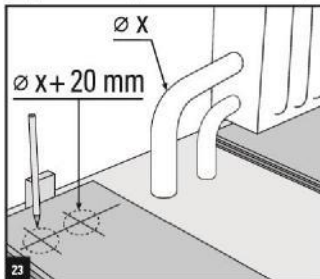
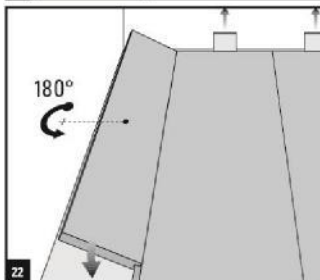
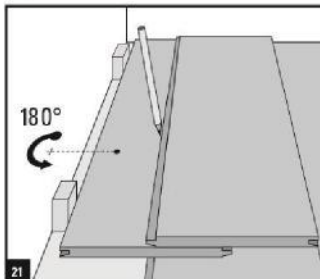
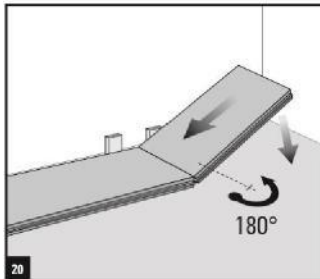
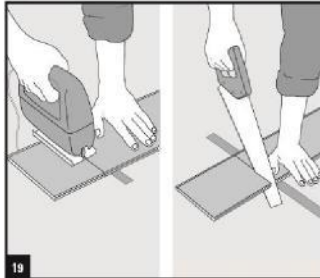
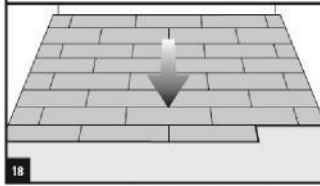
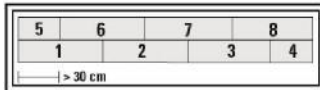

### [18]

Ensure you have a joint offset of at least 30cm to achieve a visually appealing installation pattern.

### [19]

Cut the last panel in a row to length taking the minimum edge distance of 10mm into consideration.

### [20]

Lock in the end piece of the row according to the locking system.

### [21]

To install the final row, measure the distance between the wall and the installed row. Transfer this measurement onto the panel and cut to size.

### [22]

Lock in the last row according to the locking system.

### [23]

For heating pipes, transfer the diameter of the heating pipes plus 20mm to the panel.

## Installation instructions for wineo performance laminate flooring – Rock'n'Go

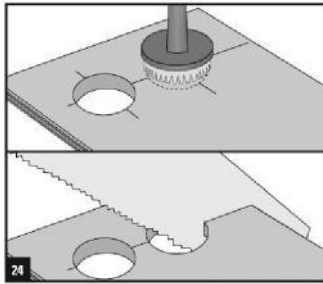

**[24]**

Cut/drill out pipe openings following the markings.  
Cut across the whole width of the panel across the centre of the hole.

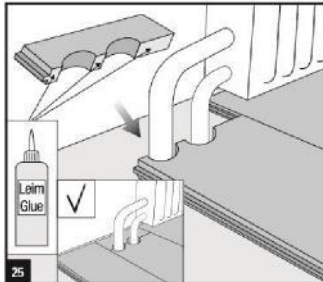

**[25]**

Glue the cut edges back together.

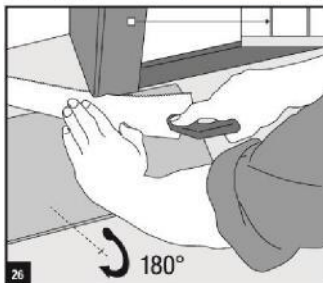

**[26]**

If necessary, shorten existing wooden door frames.

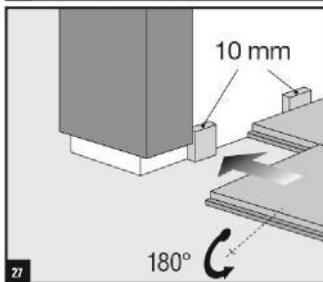

**[27]**

Observe an edge distance of at least 10mm under door frames as well.

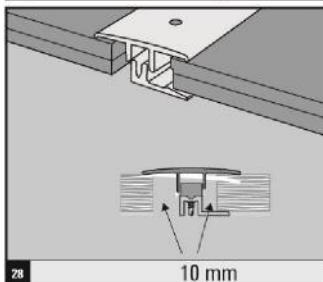

**[28]**

When installing transition or end strips, make sure the strips are never fixed to the floor covering! Maintain an edge distance of 10mm.

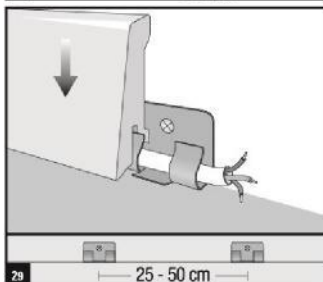

**[29]**

Remove spacers. Mount skirting boards correctly.  
Maximum fixing distance 50cm.

# Installation instructions for wineo performance laminate flooring – Rock'n'Go



## Use and care

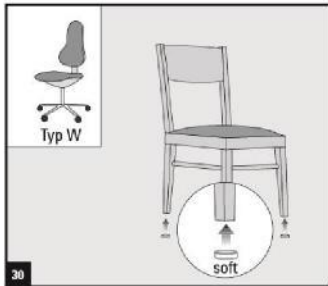

Use type W chair castors. Use suitable or soft chair and furniture slides.

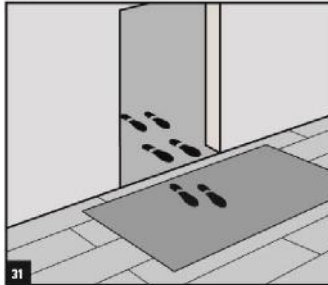

**[30]**  
Fit adequately sized dirt-trap mats.

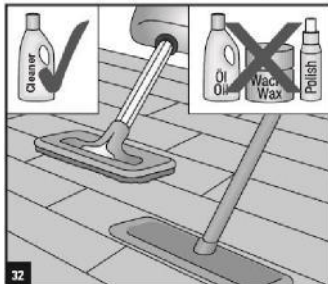

**[31]**  
Clean with a broom or vacuum cleaner. Wipe with a damp cloth. Do not use abrasive or scraping cleaning products or equipment/tools.  
Use a laminate cleaner for heavy contamination. Observe the cleaning and care instructions.

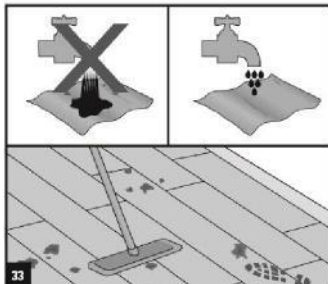

**[32]**  
When damp cleaning, please use water and cleaning agent sparingly (wipe with a damp cloth).

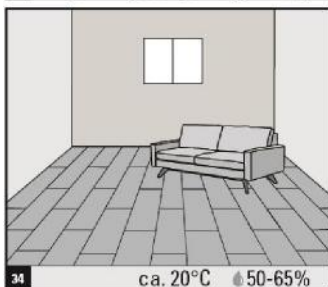

**[33]**  
Maintain a healthy environment in the room (approx. 20°C at 50–65% relative humidity) to preserve the characteristics of the floor covering and for the well-being of people using the room.

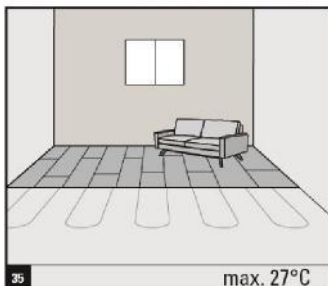

**[34]**  
For underfloor heating, the maximum continuous surface temperature may not persistently exceed 27°C.

Subject to technical modifications, dated 01/2021

